

Large Compressive Load Cell CCLG-2.0

DLM's range of Large Compressive Load Cells can be used independently or in combination as part of weighing platforms. The large range is available from 100t to 300t and manufactured using high grade stainless steel, making these load cells particularly suited to rugged environments and the hire industry amongst others. Other sized compressives can be designed upon request.



Dimensional Data

Load Cell and Saddle option

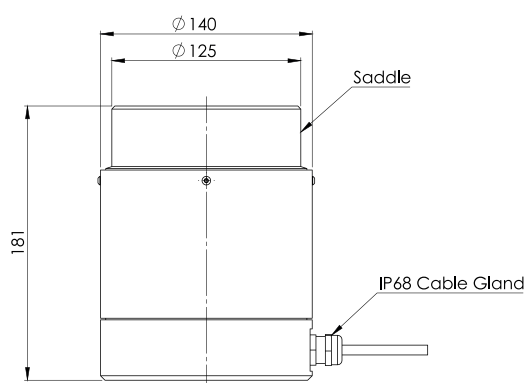

Load Cell only option

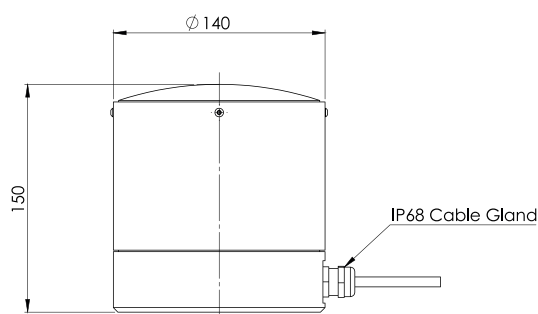

Features:

- Small, compact and portable design
- Optional load saddle
- Stainless steel construction
- Light weight

Applications:

- Tank weighing
- Hydraulic lifting operations
- Vessel weighing
- Certification

Load Capacity (Tonnes)	Part Number	Accuracy %FRO	Proof Test % Load Capacity	Weight (kg)	Resolution (kg)
100	0001 - 1083	<±0.5	150	14	100
150	0001 - 1084	<±0.5	225	14	100
200	0001 - 1085	<±0.5	300	14	100
300	0001 - 1086	<±0.5	450	14	100

Specification

Loadcell Material:	17-4PH Stainless Steel
Bridge Resistance:	700Ω
Operating Temperature range:	-10°C to +60°C
Compatible Display Units:	TW-2.0-S / Custom display
Cable:	10m signal cable standard (increased lengths available on request). Mil Spec/RM12 connector termination.
Calibration:	Supplied with calibration, proof load and test certificates to BS EN 10002/2 1992
Packaging	Packaged in rugged storm / Peli watertight case.
Optional Extras:	Load Saddle. Part Number: 0001-1227